



ASPIRE

— TO MOVE —



Alpine Gardens, Bath

Video and physical viewings available. A four bedroom student property, offered furnished from the 11th July 2026.

Alpine Gardens is located just north east of Bath city centre with the centre being only a short 0.5 mile walk away. Local shops on Walcot Street are 0.2 miles away and there is a bus stop located on London Road.

- Video viewing available
- Four bedrooms
- Great location
- Close to local amenities
- Furnished
- Available 11th July 2026
- Student property
- Holding deposit £738
- Council tax band C, if applicable

£3,200 PCM

Floor Plans

GROUND FLOOR
408 sq.ft. (37.9 sq.m.) approx.

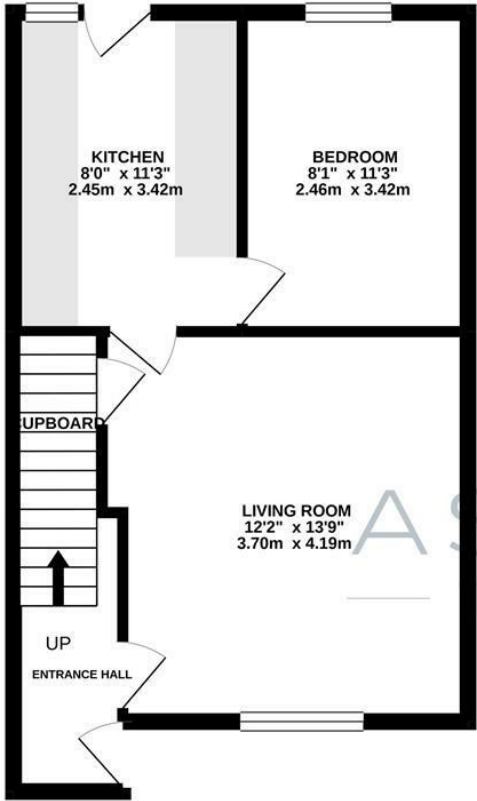

1ST FLOOR
398 sq.ft. (37.0 sq.m.) approx.

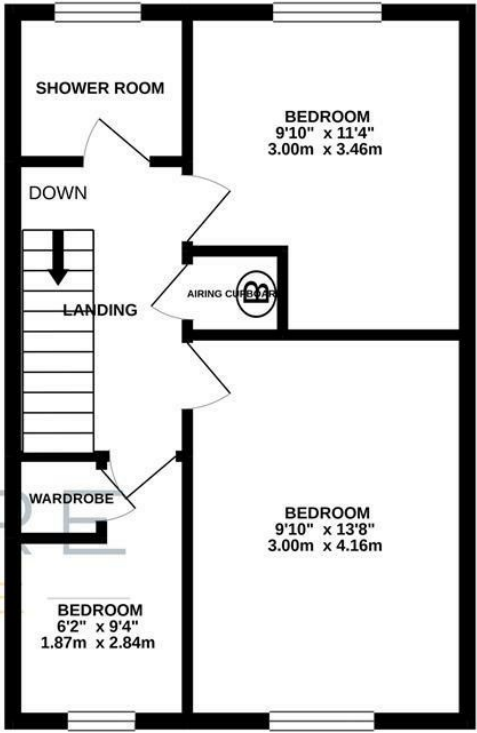

ALPINE GARDENS, BATH, BA1

TOTAL FLOOR AREA : 806 sq.ft. (74.9 sq.m.) approx.

Whilst every attempt has been made to ensure the accuracy of the floorplan contained here, measurements of doors, windows, rooms and any other items are approximate and no responsibility is taken for any error, omission or mis-statement. This plan is for illustrative purposes only and should be used as such by any prospective purchaser. The services, systems and appliances shown have not been tested and no guarantee as to their operability or efficiency can be given.
Made with Metropix ©2021

Energy Performance Graph

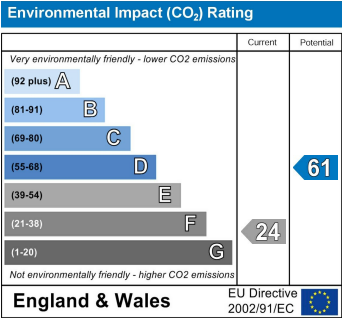
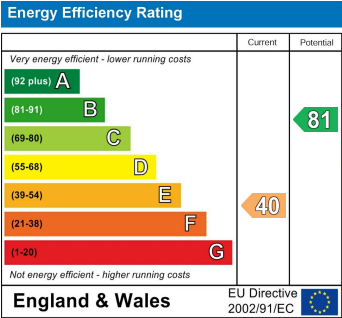

These particulars, whilst believed to be accurate are set out as a general outline only for guidance and do not constitute any part of an offer or contract. Intending purchasers should not rely on them as statements of representation of fact, but must satisfy themselves by inspection or otherwise as to their accuracy. No person in this firms employment has the authority to make or give any representation or warranty in respect of the property.